

65.473
210.03.15

9

5

DRIP LINE OF MILKWOOD FOREST

FLOOR PLAN LAYOUT - 1:100

MILKWOOD

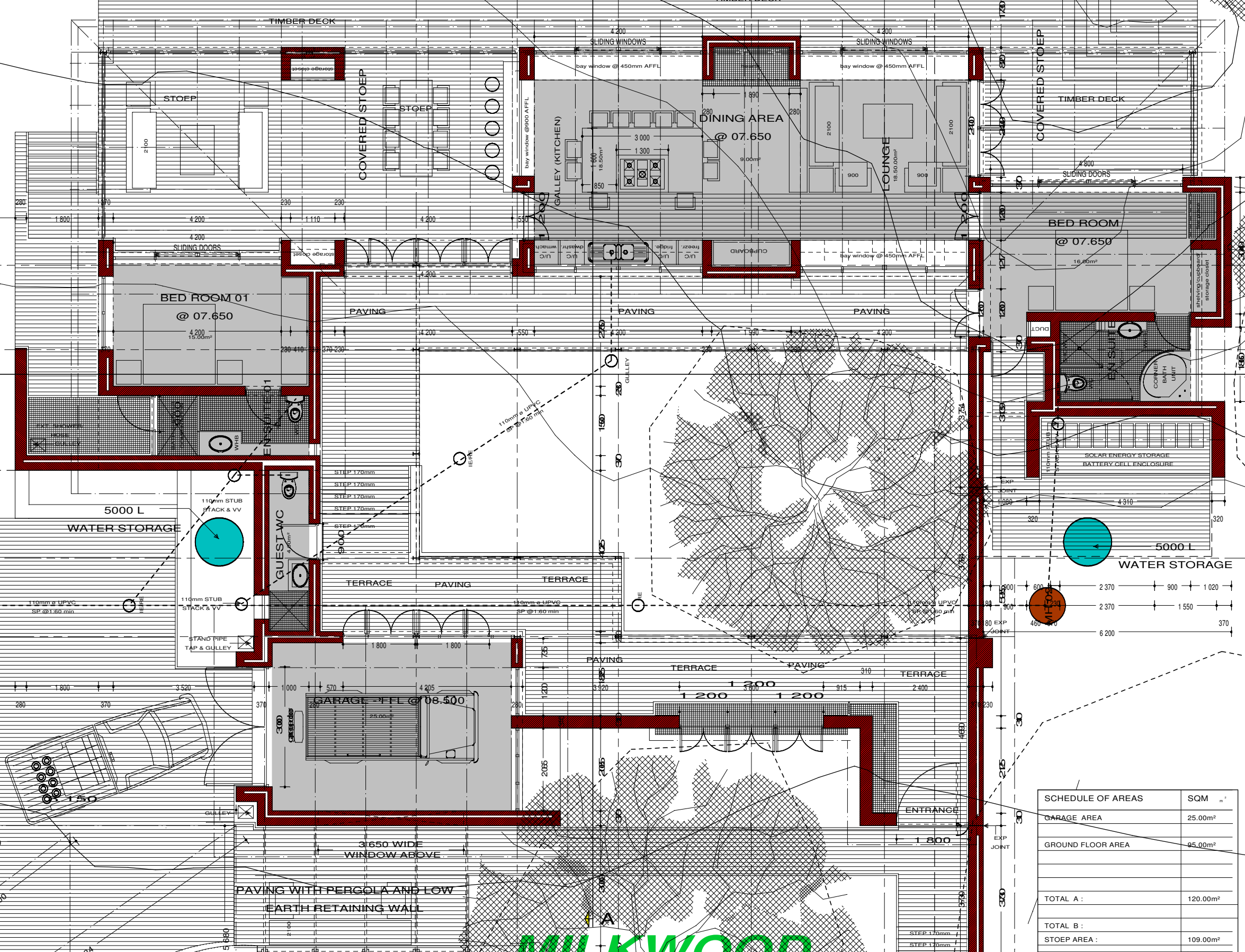

| SCHEDULE OF AREAS | SQM m ² |
|------------------------------|-----------------------|
| GARAGE AREA | 25.00m ² |
| GROUND FLOOR AREA | 95.00m ² |
| TOTAL A : | 120.00m ² |
| TOTAL B : | |
| STOEFF AREA : | 109.00m ² |
| TOTAL A + B (COVERAGE AREA) | 229.00m ² |
| COVERAGE | 9.2% |
| ERF AREA/EXTENT - PORTION 28 | 2489.00m ² |

ALL RETAINING WALLS, FOUNDATIONS, ROOFING AND HOUSING TO COMPLY WITH THE RELEVANT LOCAL AUTHORITY BYE LAWS, REGULATIONS AND REQUIREMENTS.
 ALL PLUMBING AND DRAINAGE WORK AND INSTALLATION OF SANITARY FITTINGS TO COMPLY WITH THE RELEVANT LOCAL AUTHORITY BYE LAWS, REGULATIONS AND REQUIREMENTS.
 PROVIDE INSPECTION (ROODING) EYES TO ALL BENDS, JUNCTIONS OR EVERY 25M WITH SUITABLE MARKERS AT GROUND LEVEL.
 MINIMUM FALL TO ALL DRAINAGE PIPES TO BE 1:80.
 PROVIDE APPROVED RESEAL TRAPS TO ALL WASTE FITTINGS.
 PROVIDE VENT CAPS AND/OR VENT VALVES TO ALL STACKS.
 INSPECTION VENTS TO WASTE PIPES TO BE FULLY ACCESSIBLE AT ALL TIMES.
 ALL SOIL PIPES PASSING UNDER BUILDINGS, FOOTINGS OR TRAFFIC AREAS TO BE ENCASED IN REINFORCED CONCRETE OF MINIMUM 100MM THICKNESS ALL ROUND PIPE.

PIETER SCHOONWINKEL
 ARSITEK
 T : 021 9137300
 F : 021 9789429
 C : 083 460 2001
 E : 0837012800@mtsloaded.co.za
 20 PLETTENBERG STR
 WELGEMOED
 7530

VENEZIA TRUST.
 CLIENT:
 PROPOSED NEW RESIDENCE ON PORTION 28 -
 No. 723, SEE EIKE FARM,
 WORTELGAT, STANFORD.

DOCUMENT STATUS : for APPROVAL
 GROUND FLOOR PLAN 1:100

28003
 Project, Project no.
 1100-A3-01062010
 February 2008
 Client Signature / Goedgekeur: Approved
 REVISION VERWYSING
 FILE & PROJECTS MANAGEMENT - WORTELGAT FOR APPROVAL JULY 2010 APPROVAL 1100 FLOOR PLAN A3-01062010
 COMPUTER REFERENCE